

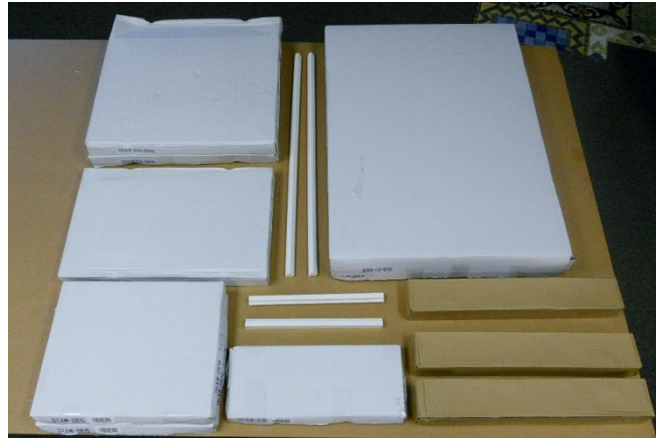

**PATENT PENDING DOOR MATCHING SOLID WOOD
EDGE TECHNOLOGY**



ASSEMBLY INSTRUCTIONS

DRAWER BASE – B12-B21

- BOX BASE CABINET
- DRAW "B" – BASE
- 2-DRAW "DB" – DRAWER BASE
- DRAW BOX "B" – BASE
- 2-DRAW BOX "DB" – DRAWER BASE
- 3 - SLIDE - UNDERMOUNT
- 20" – Base Cabinets
- 16" – Vanity Base Cabinets
- 2 - STILE EDGE
- Vertical pieces, actual size of given dimension
- 2 - RAIL EDGE
- Horizontal pieces, 1-1/2" shorter than given dimension

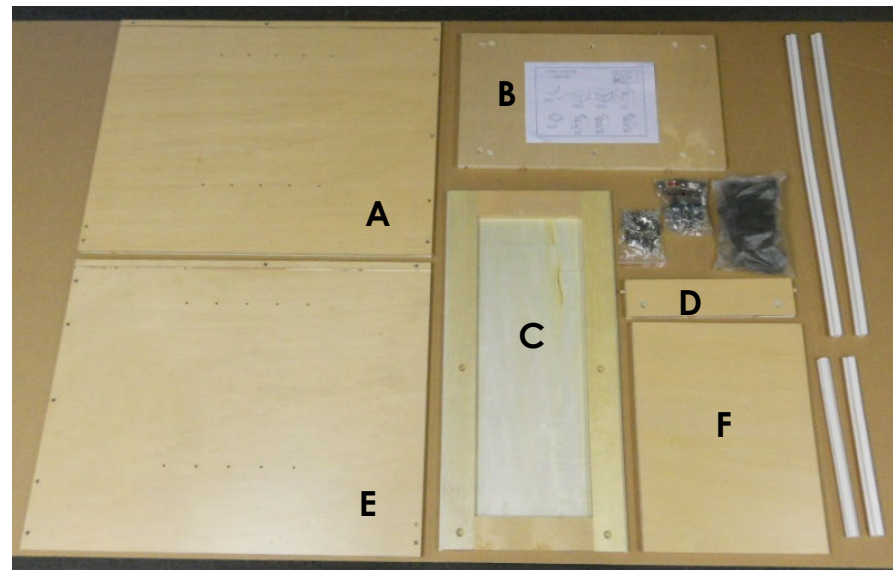

BOX BASE CABINET



CAM SCREW



CAM LOCK

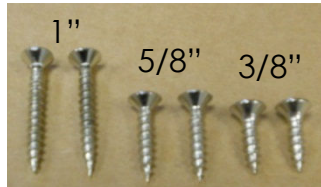

ASSORTED SCREWS



STILE & RAIL EDGES
* SHIPPED IN LABELED BUNDLES



SHELF SUPPORT



HINGES



ADJUSTABLE LEGS



3-SLIDE BOX SET



DRAWER "K" CLIPS



DRAWER BOXES



DRAW FRONTS



RECOMMENDED TOOLS
(DRILL OPTIONAL)

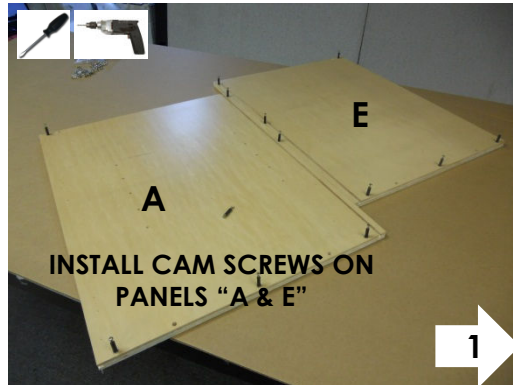

**INSTALL CAM SCREWS ON
PANELS "A & E"**



**INSTALL SLIDES ON "A & E"
USING PRE-DRILLED HOLES**

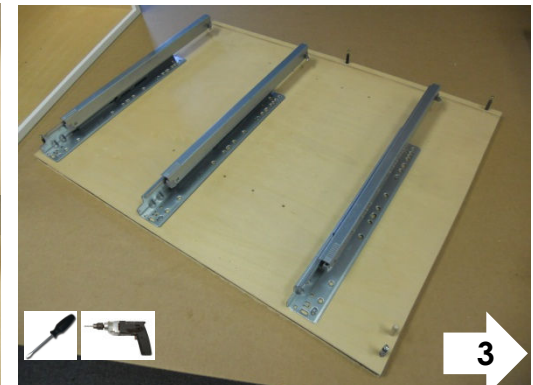

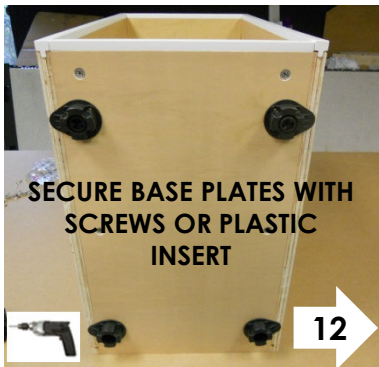
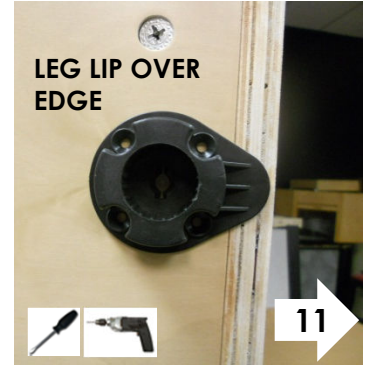
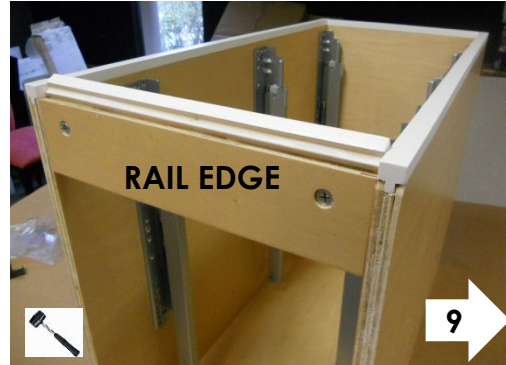
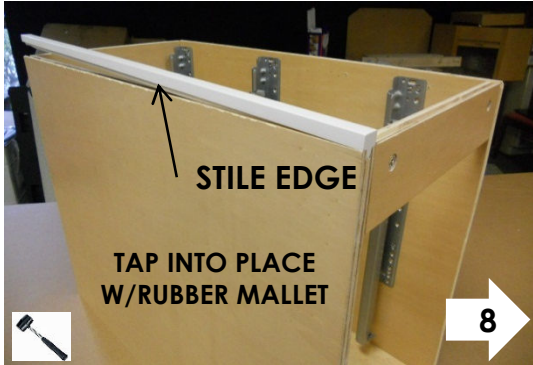
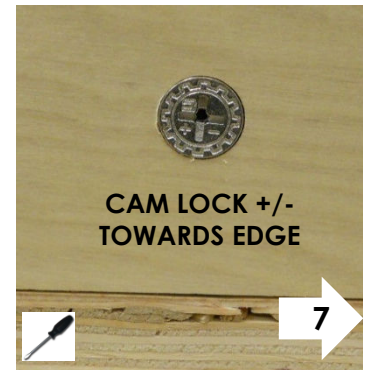
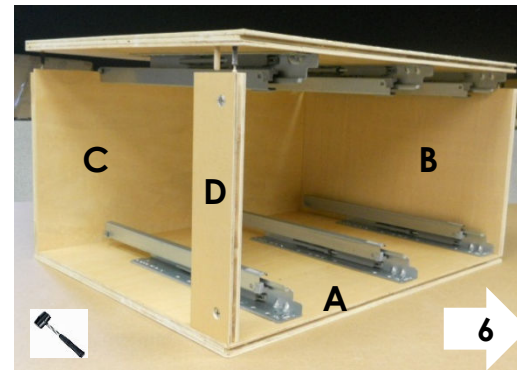
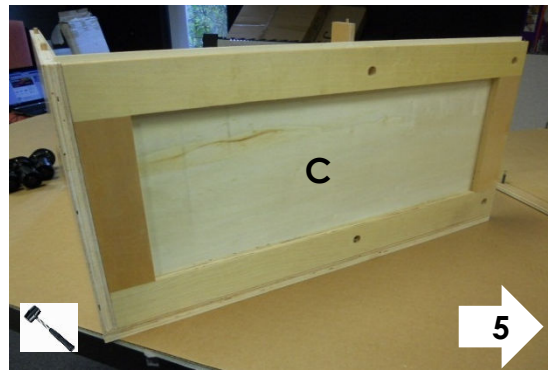
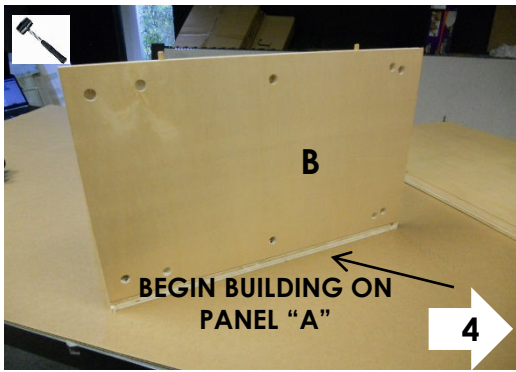

LOCATE AND OPEN DRAWER BOXES

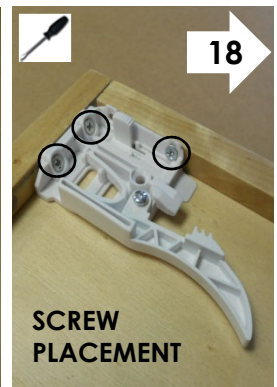
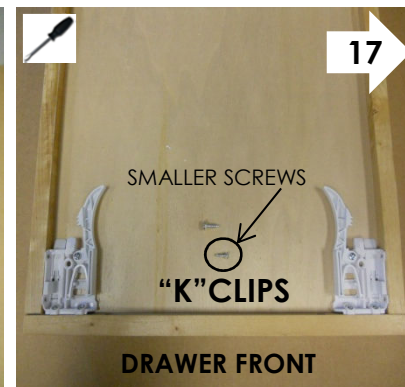
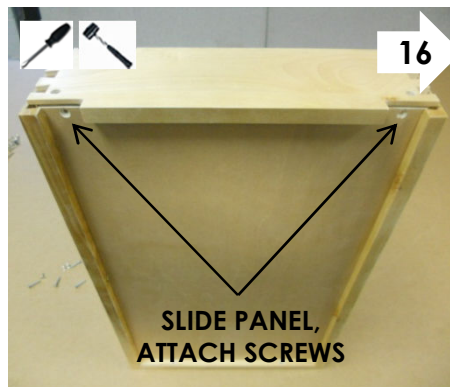
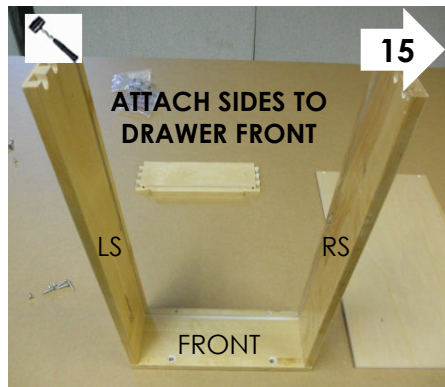
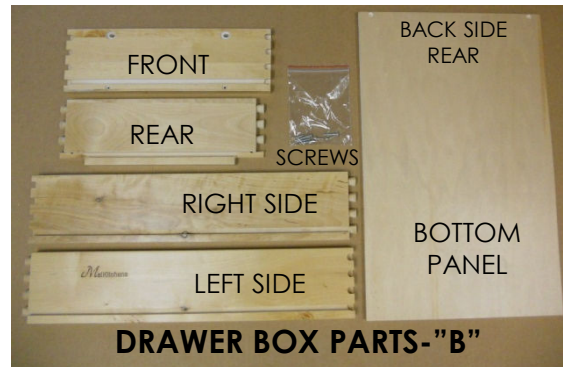

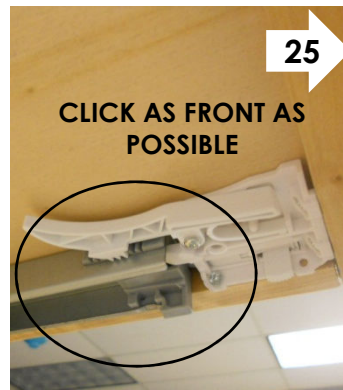
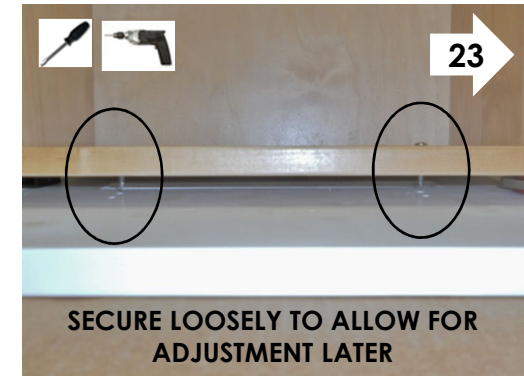
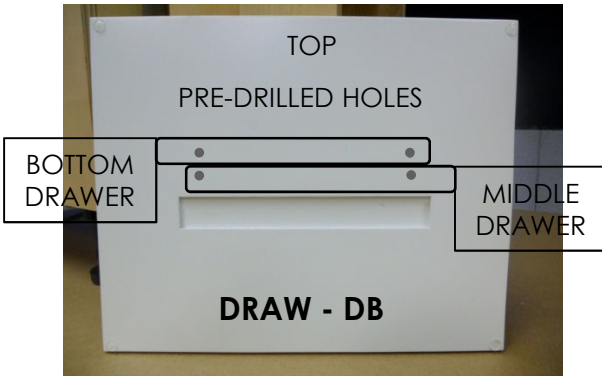
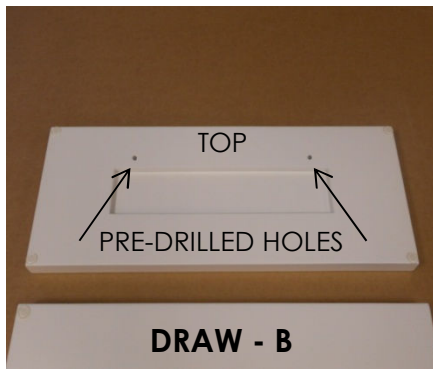

ALIGN ALL DRAWER FACES, TIGHTEN THE TOP SCREWS AND THEN REMOVE DRAWERS TO INSTALL BOTTOM SCREWS

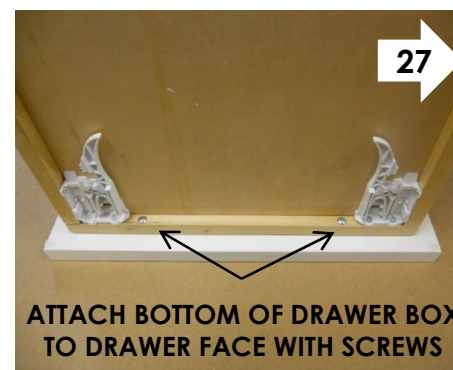
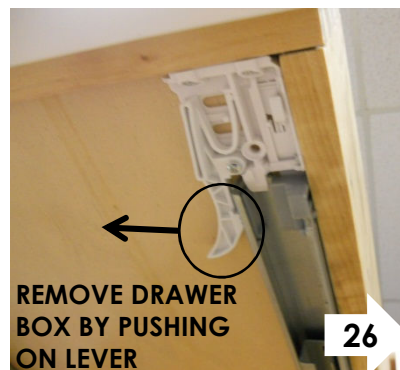

FINAL PRODUCT