

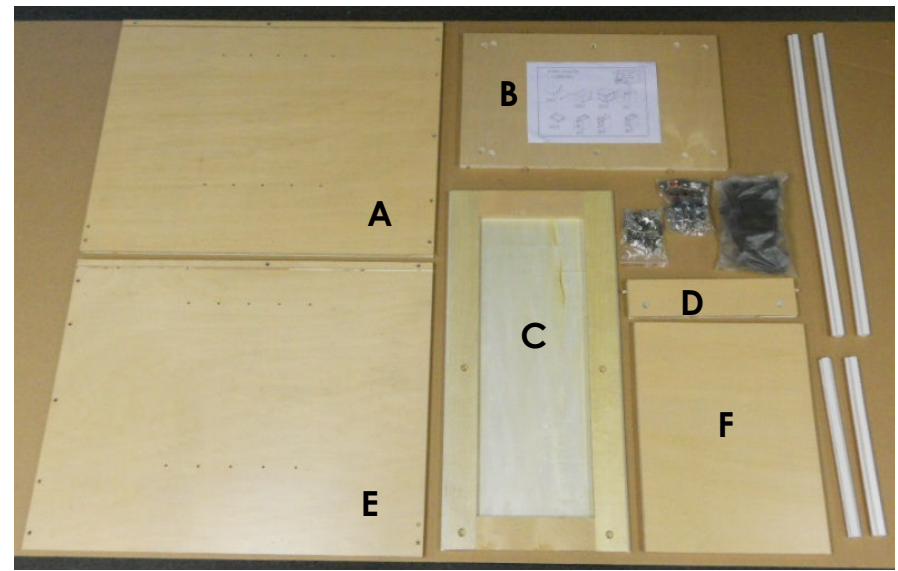

**PATENT PENDING DOOR MATCHING SOLID WOOD
EDGE TECHNOLOGY**



BOX BASE CABINET
DOOR "B" – BASE
DRAW "B" – BASE
DRAW BOX "B" – BASE
SLIDE - UNDERMOUNT
20" – Base Cabinets
16" – Vanity Base Cabinets
2 - STILE EDGE
Vertical pieces, actual size of given
dimension
2 - RAIL EDGE
Horizontal pieces, 1-1/2" shorter
than given dimension

ASSEMBLY INSTRUCTIONS
BASE DRAWER/DOOR - B9-B21

BOX BASE CABINET



CAM SCREW



CAM LOCK

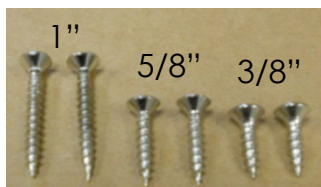

ASSORTED SCREWS



STILE & RAIL EDGES
* SHIPPED IN LABELED
BUNDLES



SHELF SUPPORT



HINGES



ADJUSTABLE LEGS



SLIDE BOX SET



DRAWER "K" CLIPS



DRAWER BOX



DOOR/DRAW FRONTS



RECOMMENDED TOOLS
(DRILL OPTIONAL)

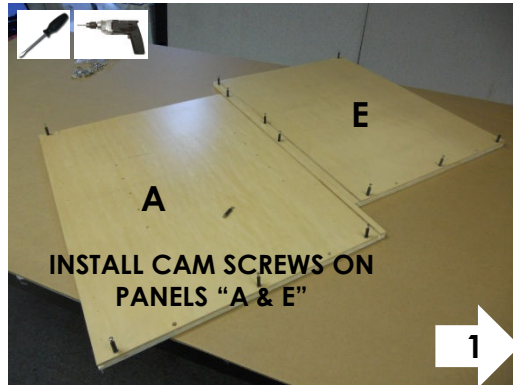

INSTALL CAM SCREWS ON
PANELS "A & E"

1

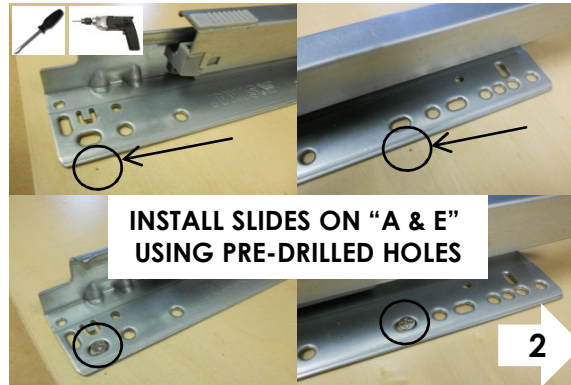

INSTALL SLIDES ON "A & E"
USING PRE-DRILLED HOLES

2

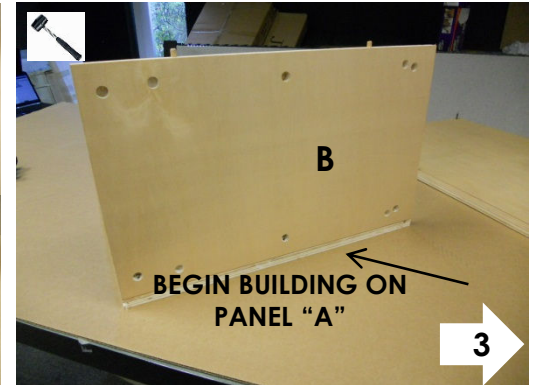

BEGIN BUILDING ON
PANEL "A"

3

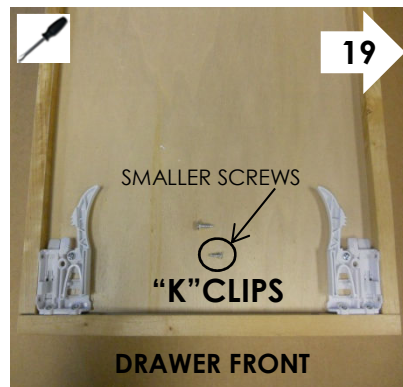
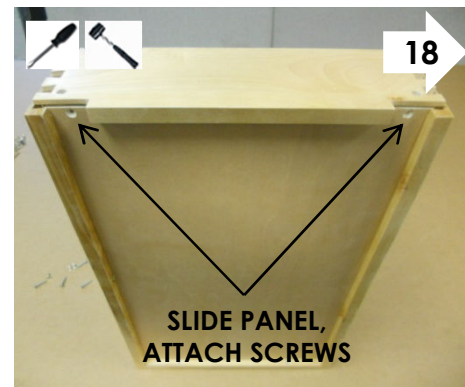
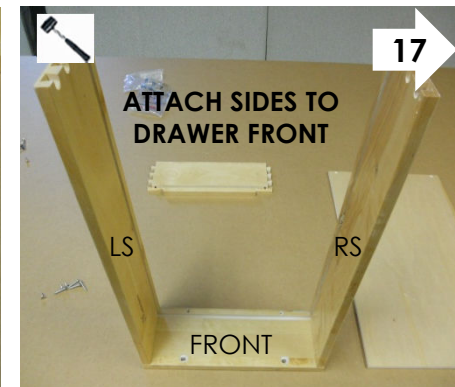
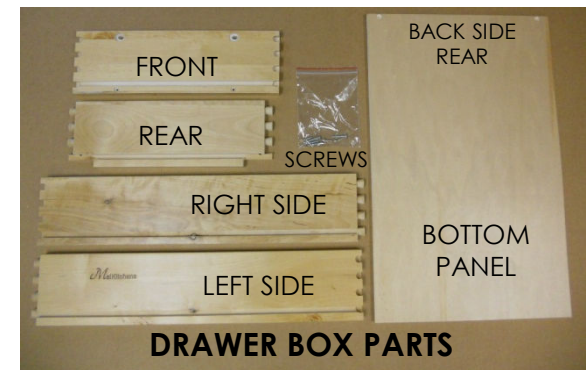
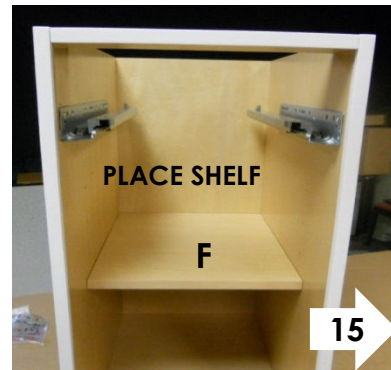
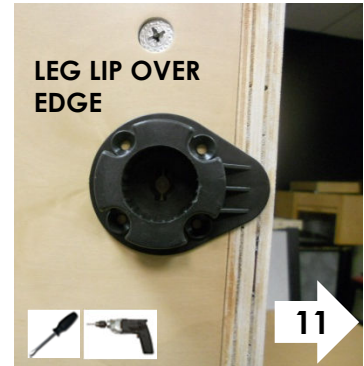
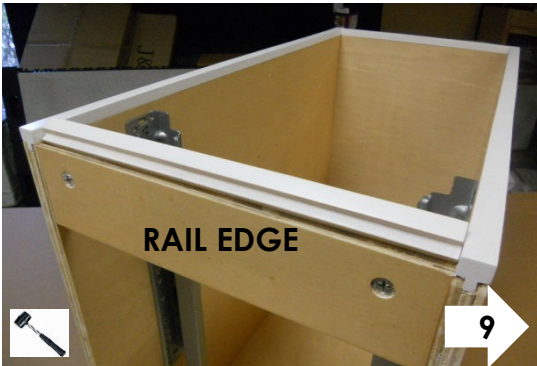
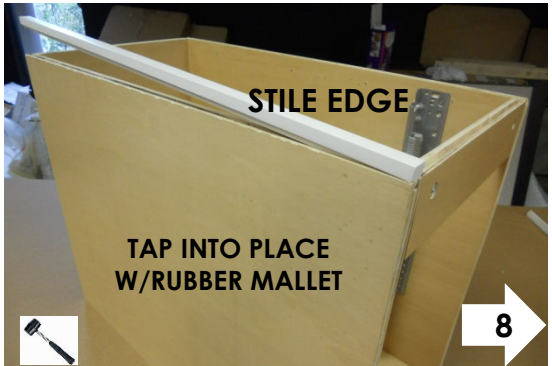
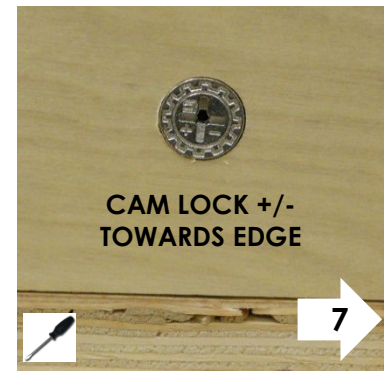
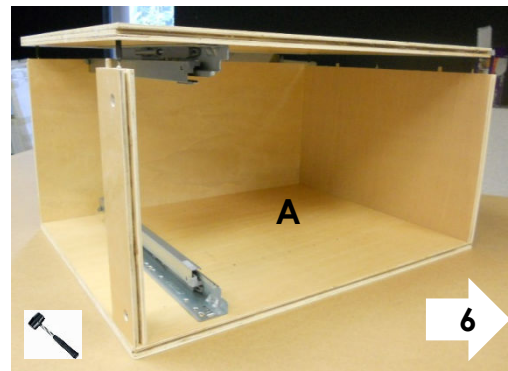
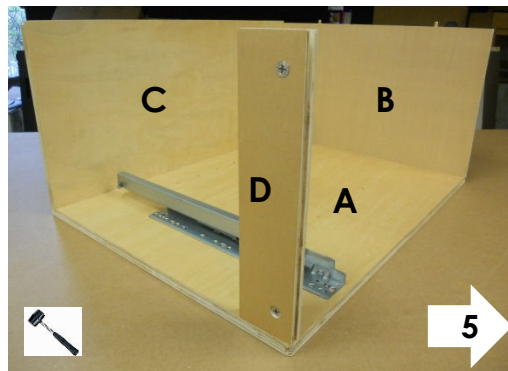
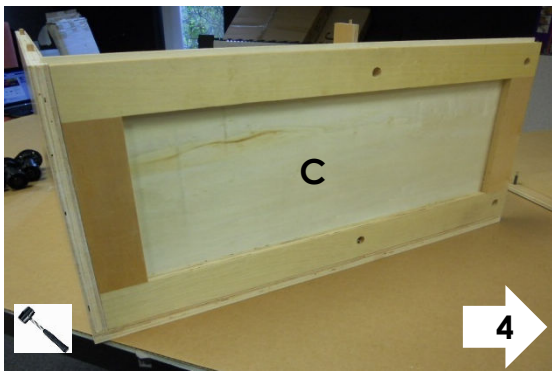

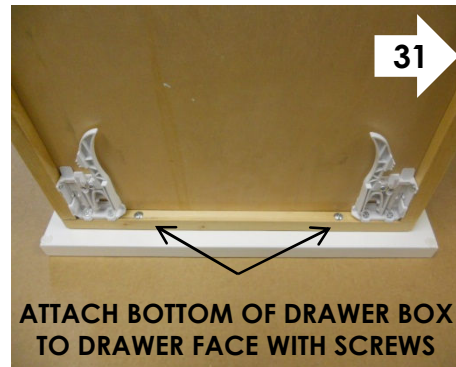
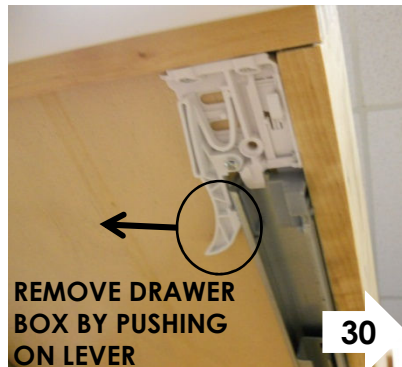
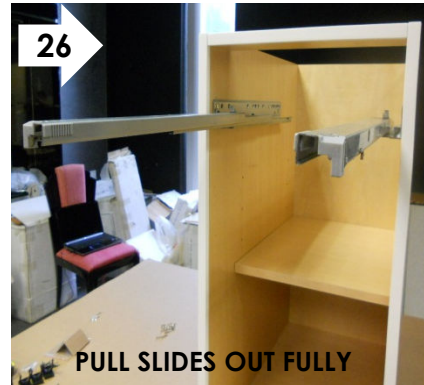
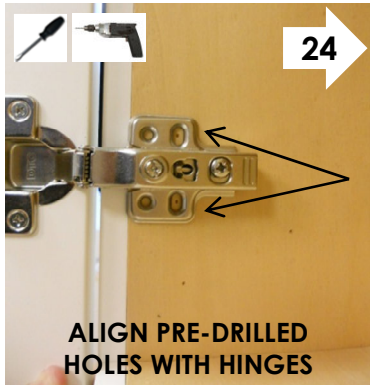
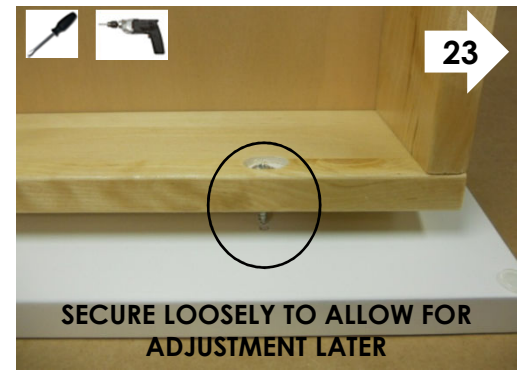
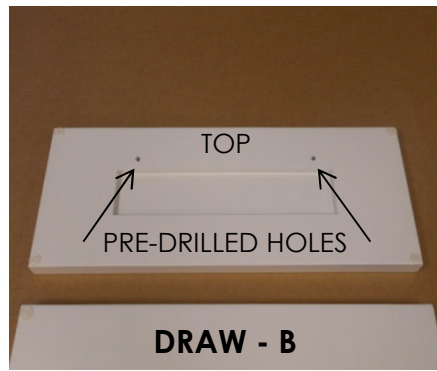
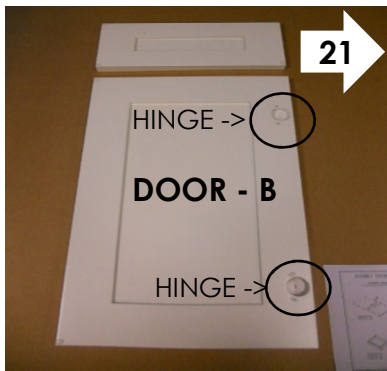

RE-INSTALL DRAWER BOX AND MAKE FINAL ADJUSTMENTS ON DOOR AND DRAWER

